

# Scavenger Kit - Assembly for Sidestream Capnographs

Step 1, insert the part no. 1963 with a small outlet side port into your scavenging tube

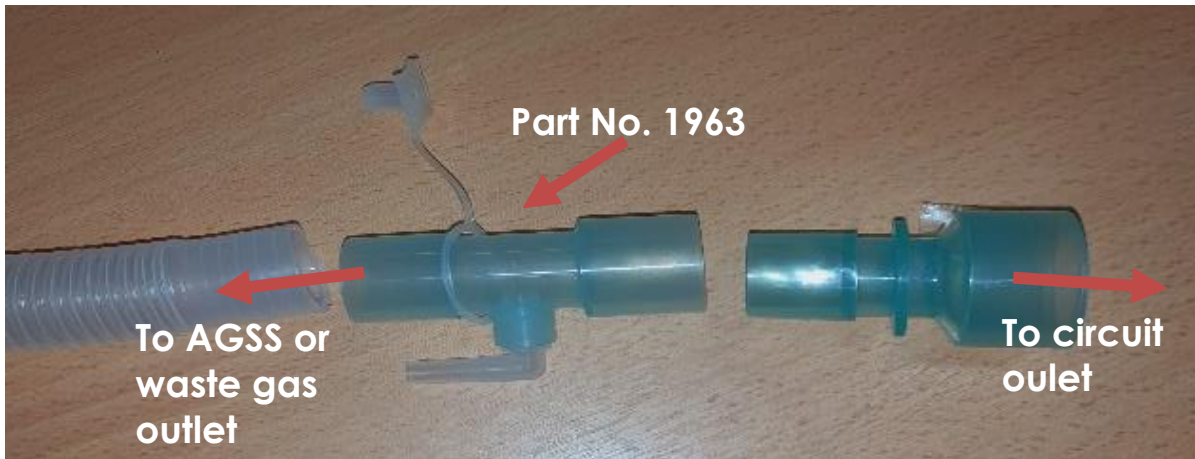

Step 2, push the larger wide silicone tube (ST08050) onto the side port



Step 3, Now link the wide bore and narrow bore tubes together with the tapered connector VY-881.37

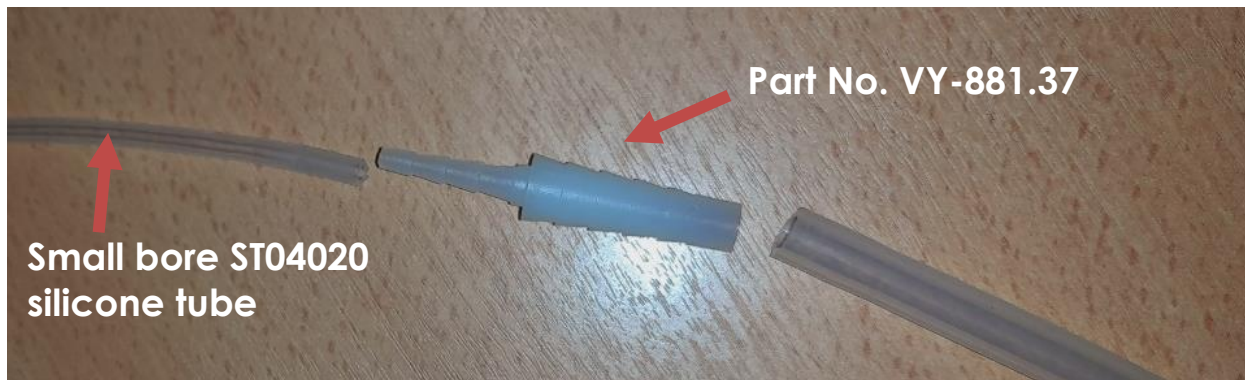

Step 4, Finally, connect the narrow bore tube onto the exhaust port of your Capnograph Sidestream on the multi-parameter



This will allow you to pass the used sample gas back in to your scavenging tube to be removed from the building

**Any question please contact our Technical Sales Team  
on 0800 0683300 or [info@vet-direct.com](mailto:info@vet-direct.com)**